

Notice:

1. Backcheck valve can not be closed completely.
2. Don't use external force when the door is closing, otherwise the door closer may be damaged.

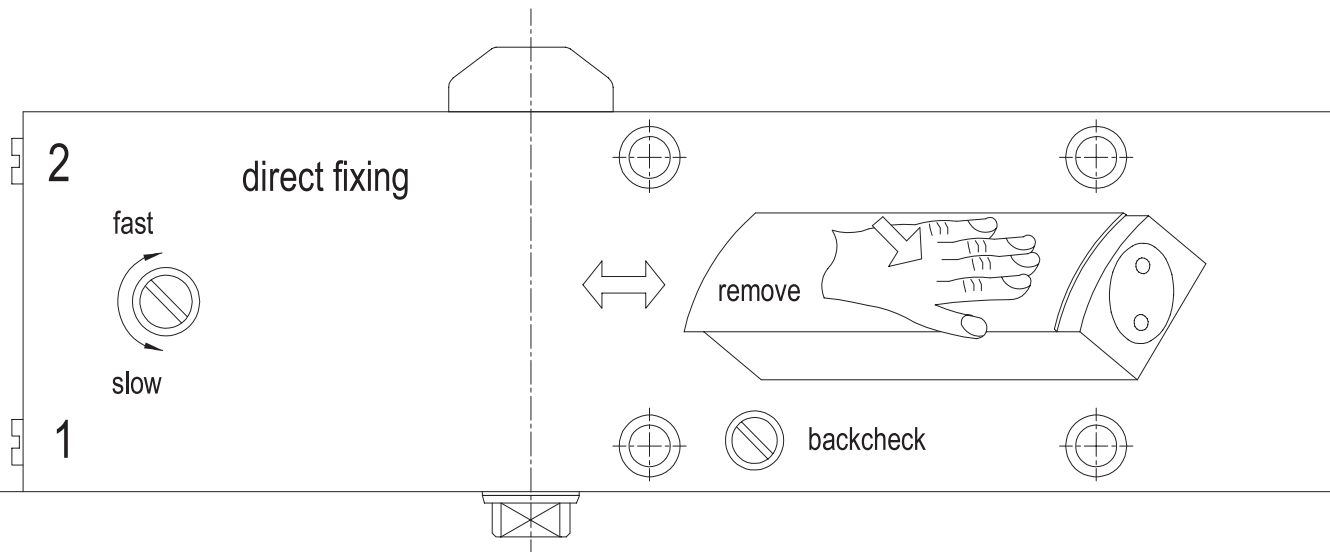

↑
top edge of door

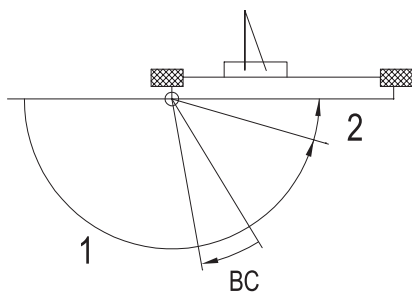

Hinge



IRSS Briton Closer-BNT200 Series installation Top Jamb -Push Side Mounted

REVISED INSTALLATION TEMPLATE

DISREGARD INSTALLATION TEMPLATE
ENCLOSED IN PACK

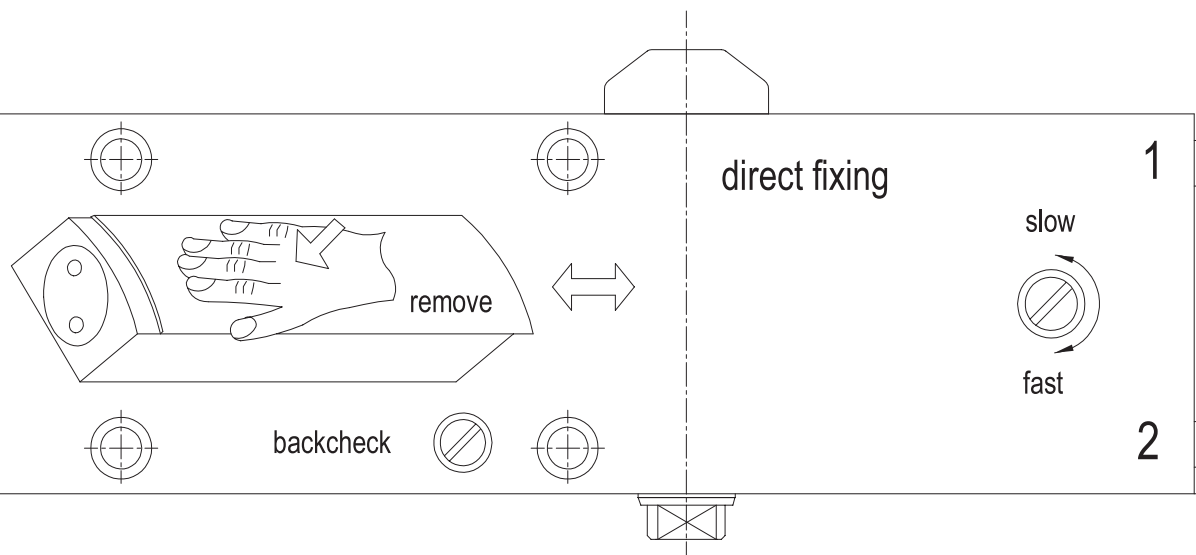

Notice:

1. Backcheck valve can not be closed completely.
2. Don't use external force when the door is closing, otherwise the door closer may be damaged.

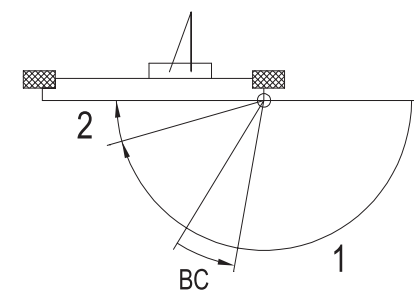

top edge of door

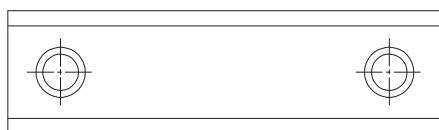

IRSS Briton Closer-BNT200 Series installation

Top Jamb -Push Side Mounted

Hinge

