

ASSA ABLOY is the global leader in door opening solutions, dedicated to satisfying end-user needs for security, safety and convenience



## Please Note:

This document is provided as a dimensional reference and should not be printed as a drilling template unless it can be correctly scaled to 100% by your printer.

ASSA ABLOY Australia Pty Limited  
235 Huntingdale Road,  
Oakleigh Victoria, 3166  
Australia

[info.au@assaabloy.com](mailto:info.au@assaabloy.com)  
[assaabloy.com.au](http://assaabloy.com.au)

ASSA ABLOY New Zealand Ltd.  
6 Armstrong Road  
Albany, North Shore City, 0632  
New Zealand

[info.nz@assaabloy.com](mailto:info.nz@assaabloy.com)  
[assaabloy.co.nz](http://assaabloy.co.nz)

**FOLLOW INSTRUCTIONS CAREFULLY**

**NOTE:** Glazed doors require minimum side rail as shown.

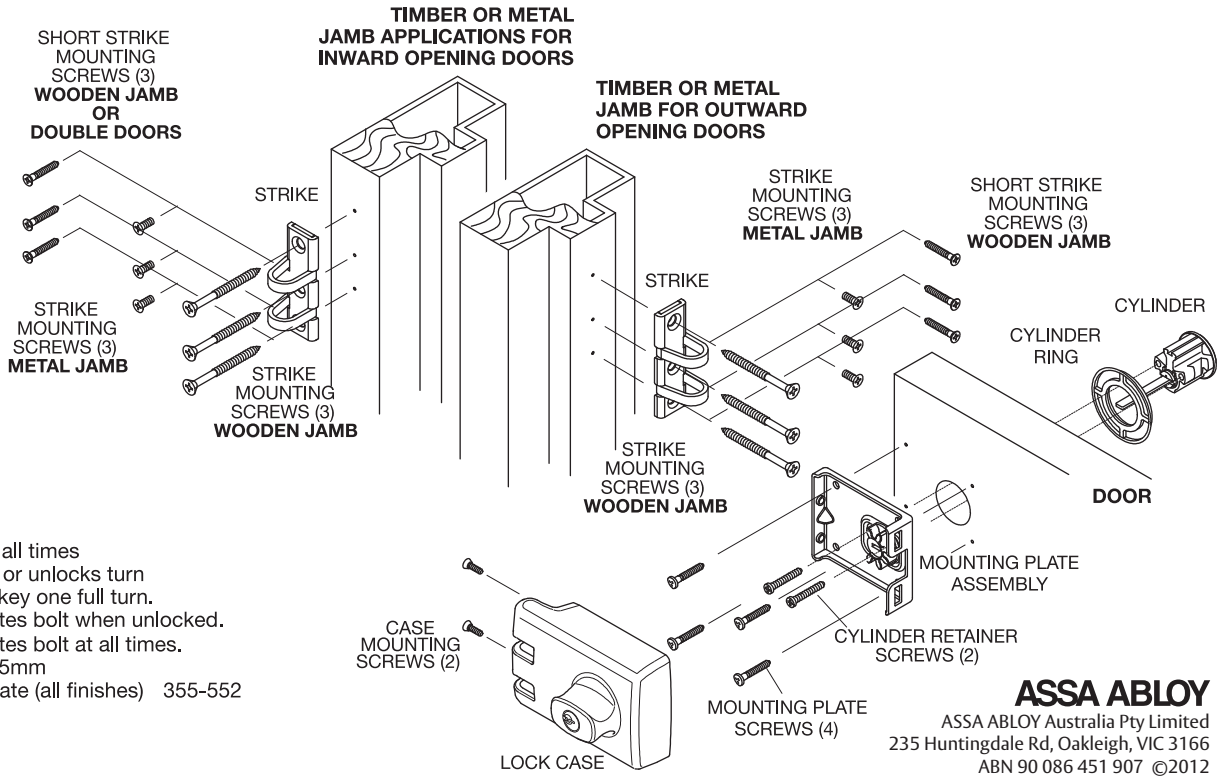
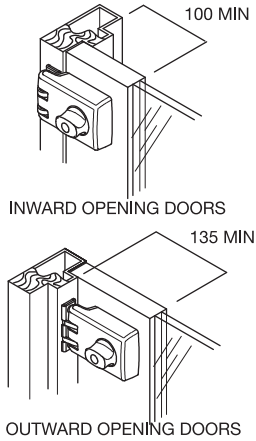

**LOCK OPERATION**

- KEY OUTSIDE:** Operates bolt at all times
- KEY INSIDE :** (355 only) Locks or unlocks turn knob by turning key one full turn.
- TURN KNOB :** (355 only) Operates bolt when unlocked.
- TURN KNOB :** (303 only) Operates bolt at all times.
- DOOR THICKNESS** 30mm to 45mm
- OPTIONAL** Flanged strike plate (all finishes) 355-552

**ASSA ABLOY**

ASSA ABLOY Australia Pty Limited  
 235 Huntingdale Rd, Oakleigh, VIC 3166  
 ABN 90 086 451 907 ©2012

The global leader in door opening solutions

**A. PREPARE DOOR**

1. Select side of template to suit door opening direction.
2. Position template and prepare door as specified on template. Ensure lock position is not in hollow section of door.

**- OUTWARD OPENING -**  
**TIMBER OR METAL JAMB**

**- INWARD OPENING -**  
**TIMBER OR METAL JAMB**  
**& DOUBLE DOORS**

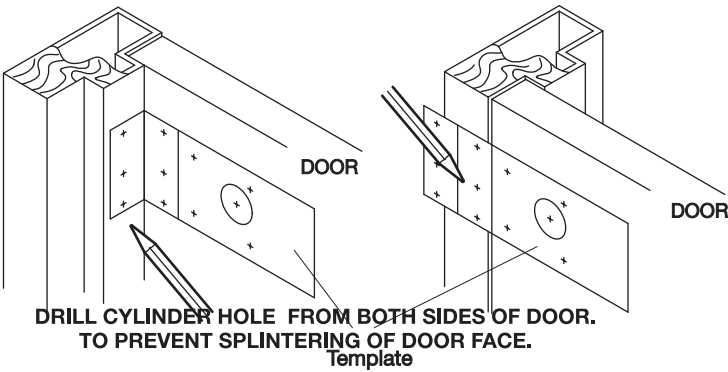

**B. PREPARE LOCK**

1. Remove two case mounting screws from lock case.
2. Remove mounting plate out of lock case.

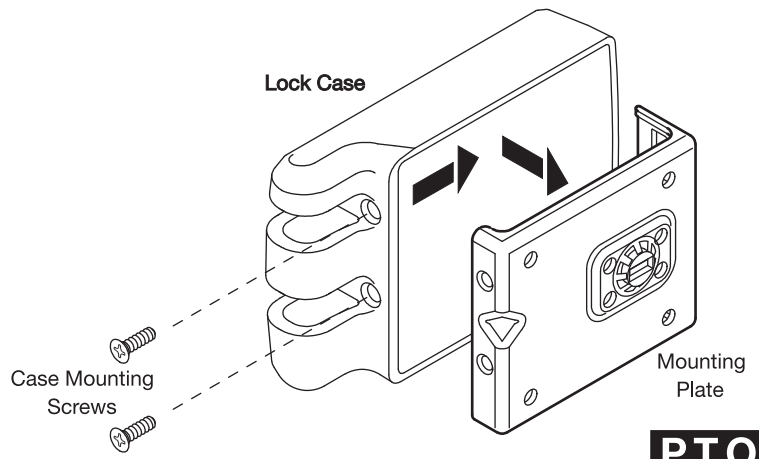

**P.T.O.**

**OUTWARD OPENING DOORS ONLY**

**INWARD OPENING DOORS ONLY**

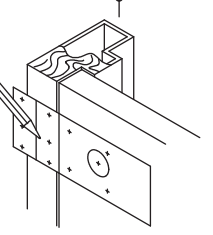
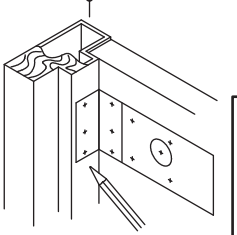

FOR WOODEN JAMB DRILL 3 HOLES	
LONG SCREWS	4.7mm (3/16") Dia x 57 (2 1/4") Deep
SHORT SCREWS	4mm (5/32") Dia x 20mm (3/4") Deep
FOR METAL JAMB DRILL 3 HOLES	
METAL SCREW	4.3mm (1/16") Dia

**LINE C**

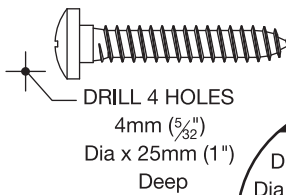

**THIS WAY UP**



**DRILL CYLINDER HOLE FROM BOTH SIDES OF DOOR TO PREVENT SPLINTERING OF DOOR FACE**

TO ASSIST WITH ALIGNMENT OF EXISTING HOLE PRIOR TO MARKING

**Template**

**TEAR OFF**

1. Select side of template to suit door opening direction.  
 NOTE : Use other side for opposite direction.
2. **FOR INWARD OPENING DOORS**  
 Place template on inside door face at required height from floor with **LINE A** positioned on door edge.  
  
**FOR OUTWARD OPENING DOORS**  
 Place template on inside door face at required height from floor with **LINE B** positioned against jamb.
3. Mark and drill holes as specified on template.

### C. INSTALL CYLINDER & MOUNTING PLATE

1. Fix MOUNTING PLATE to door with four woodscrews supplied.
2. Insert cylinder into cylinder ring and place through hole from OUTSIDE of door. Mark connecting bar flush with inner hub face, then cut 1mm shorter than mark.
4. Ensure gear teeth on the hub, face towards back of mounting plate, as shown.
5. Assemble cylinder, ensure connecting bar engages in hub slot.
6. Place FRONT retainer screw through gap in hub and secure cylinder assembly to door.
7. Rotate HUB 90 by inserting key in cylinder, and secure second retainer screw. Ensure both screws are tightened firmly.

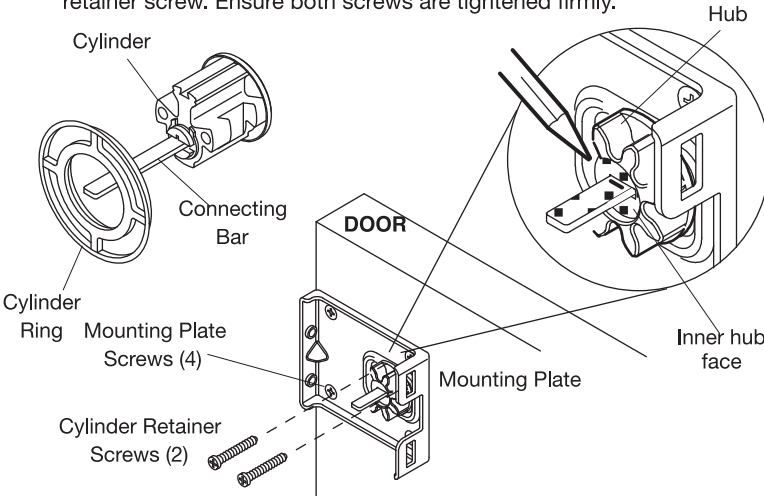

### D. INSTALL CASE

1. Ensure gear teeth on hub face towards back of mounting plate, with key removed from external cylinder. Fit case to mounting plate as shown.
2. Secure to mounting plate using two case mounting screws.

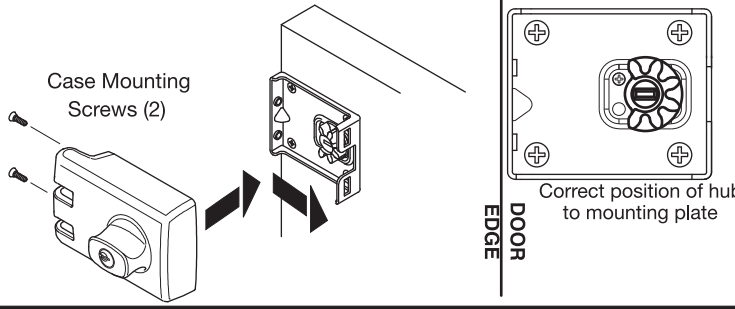

1. Insert strike face plate into strike. Ensure jamb is flush with door face.
2. Using desired screws (as shown) assemble strike to door jamb.
3. **WARNING:** Care must be taken when drilling and affixing screws to jamb. Screws must **NOT** come in contact with electrical wires in jamb.

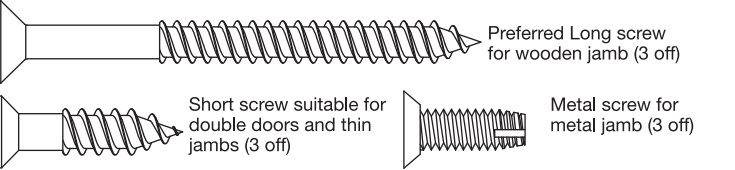

### TIMBER OR METAL JAMB APPLICATIONS

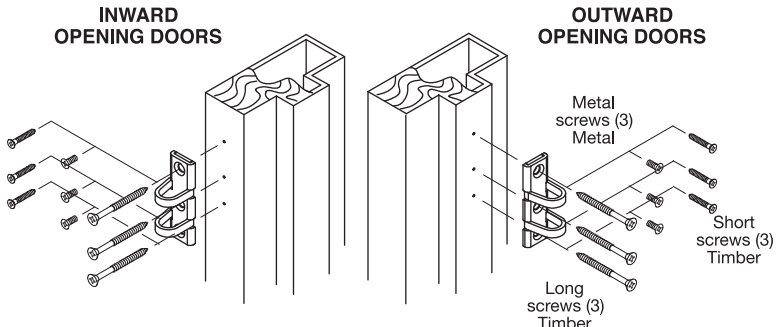

### F. OPTIONAL Retrofit FLANGE STRIKE PLATE

1. Position strike on jamb so that top of strike is aligned with top of case **LINE C**. Ensure jamb is flush with door face.
2. Mark outline of flanged strike plate on jamb. Mortice area for strike flange - until flange is flush with jamb face.
3. **WARNING:** Care must be taken when drilling and affixing screws to jamb. Screws must **NOT** come in contact with electrical wires in jamb.
4. Secure using long strike mounting screws. **Note:** Drill 4.7mm ( $\frac{3}{16}$ " Dia x 57mm ( $2\frac{1}{4}$ " Deep
5. Close door and operate lock to ensure that flanged strike and lock are correctly aligned.
6. Mark and drill two holes for flange screws 4mm ( $\frac{5}{32}$ " x 20mm ( $\frac{3}{4}$ " Deep. Fix flange strike screws.

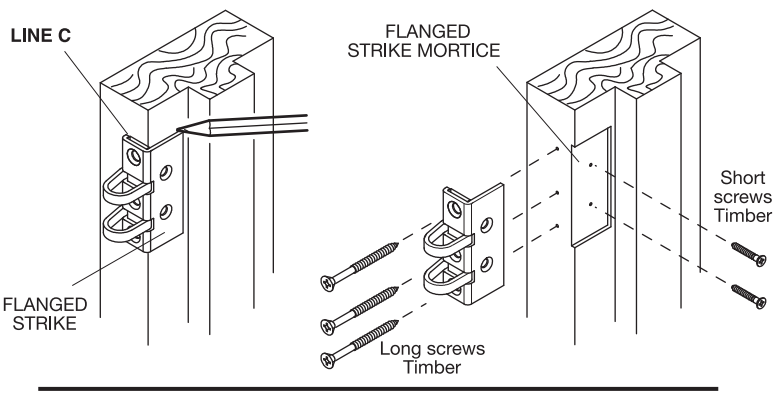

### Template

TEAR OFF

1. Select side of template to suit door opening direction. **NOTE:** Use other side for opposite direction.
2. **FOR INWARD OPENING DOORS**  
Place template on inside door face at required height from floor with **LINE A** positioned on door edge.
- FOR OUTWARD OPENING DOORS**  
Place template on inside door face at required height from floor with **LINE B** positioned against the jamb.
3. Mark and drill holes as specified on template.

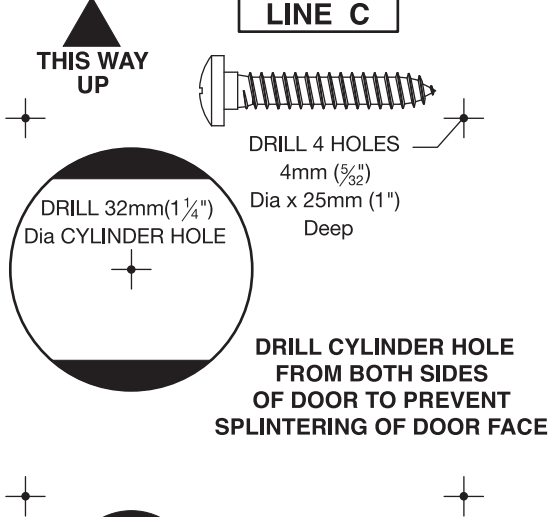

### INWARD OPENING DOORS ONLY

FOR WOODEN JAMB DRILL 3 HOLES	
LONG SCREWS	4.7mm ( $\frac{3}{16}$ " Dia x 57 ( $2\frac{1}{4}$ " Deep
SHORT SCREWS	4mm ( $\frac{5}{32}$ " Dia x 20mm ( $\frac{3}{4}$ " Deep
FOR METAL JAMB DRILL 3 HOLES	
METAL SCREW	4.3mm ( $\frac{11}{64}$ " Dia

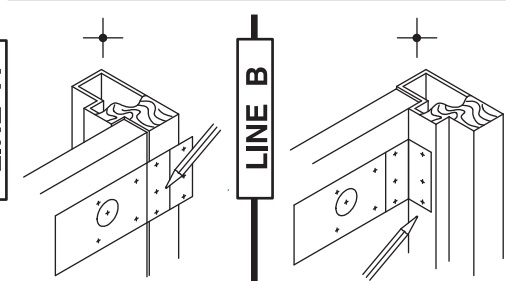

TO ASSIST WITH ALIGNMENT OF EXISTING HOLE PRIOR TO MARKING