



# Product Catalogue



[www.australianlock.com.au](http://www.australianlock.com.au)



# Contents

## **BiLock Product Catalogue**

Introduction	<b>A1</b>
Colour Key System	<b>A2</b>
Rim Lock Cylinders	<b>A3 - A4</b>
Camlocks	<b>A5 - A6</b>
Deadlocks	<b>A7</b>
Euro Din Lock Cylinders	<b>A8 - A9</b>
Mortice Lock Cylinders	<b>A10 - A11</b>
Padlocks	<b>A12 - A14</b>
Switch Locks	<b>A15 - A16</b>
Key In Knob Lock/Lever Lockset Cylinders	<b>A17 - A18</b>
Sliding Door Lock Cylinders	<b>A19</b>
Supplementary Products	<b>A20 - A22</b>
BiLock Warranty	<b>A23</b>

# BiLock New Generation

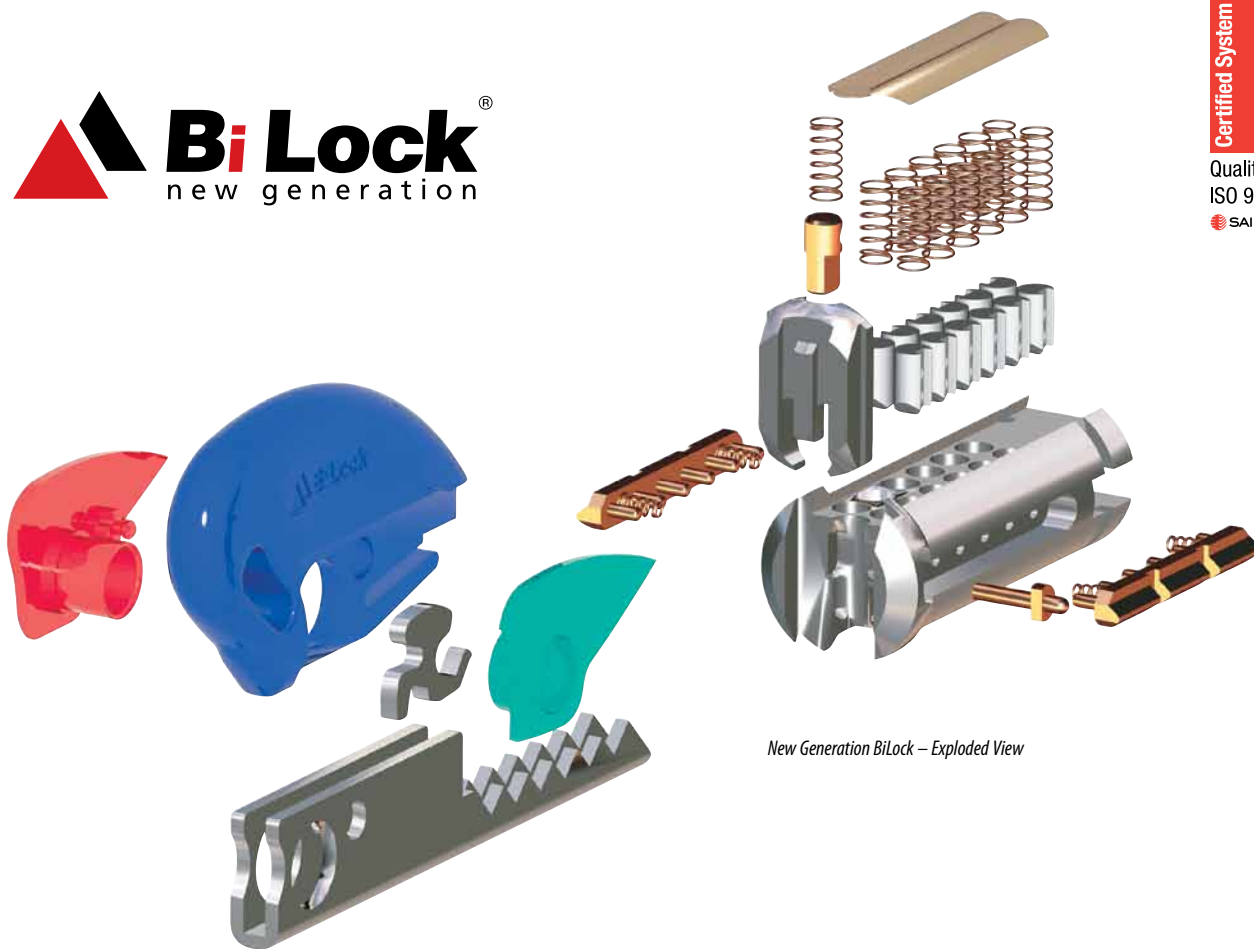

New Generation BiLock – Exploded View

BiLock's distinctive dual edged key and logo symbolise innovation, quality and reliability. These prime features have been recognised through the numerous design awards Australian Lock Company has received over the years.

Since introducing the BiLock high security Master Key range to the market over 30 years ago, Australian Lock Company has continued to re-engineer, evolve and refine the BiLock product range. The most recent development has been BiLock New Generation.

BiLock New Generation offers an intelligent new design and twin bladed key that operates a 12 pin programme of tumbler pins – 6 on either side. These pins in turn activate 2 sidebars to provide the end-user with up to 16,770,000 possible lock, key or cylinder combinations.

In addition to a space age moving component within the key, a uniquely shaped, horizontally positioned security rod has been built into the cylinder to activate the 13th locking dimension. Without

this component the 13th dimension cannot be activated which adds yet another feature to BiLock's exceptional level of quality.

The BiLock innovation has continued with the development of BiLock Quick Change Core or QCC. Now with QCC, re-keying can be as simple as withdrawing a plug & replacing it with another in a matter of seconds.

#### The main features of BiLock QCC are:

- Simplicity: easy to use with minimum maintenance
- Durability: fewer moving parts and a stronger key
- Tamper Resistance: a high level of pick resistance
- Flexibility: up to 17,000,000 combinations
- Compatibility: BiLock New generation and BiLock QCC can retrofit almost all hardware
- Cost Effectiveness: competitively priced to install and maintain.

• Locally manufactured, distributed and supported by the privately owned and operated Australian Lock Company.

Only authorised BiLock agents have permission to design, manufacture, install and maintain your BiLock high security master key system. Their ability to quickly change combinations and cut new or additional keys, means your system and security is never compromised.

In addition your BiLock agent will maintain and update your key registration details to ensure the integrity of your high security master key system at all times.

# BiLock Products

## The BiLock New Generation Colour Key System



BiLock New Generation has a new futuristic key head specifically designed to incorporate extensive colour coded master keying capabilities ensuring optimal security.

One, two or three different colours can be mixed & matched from the 20 colours available in any key head. This means a maximum of 8,000 colour combinations are available.

This new key head allows instant identification of keys by system managers & building supervisors & with ease visibly defines levels within a master key system.

# BiLock Products

## Rim Lock Cylinders

### Product

New Generation BiLock's range of rim lock cylinders offers a complete line of replacement door cylinders to retrofit most heavy-duty door hardware. The rim lock cylinder allows key access only and is most frequently used on doors to higher security areas within commercial, industrial and household environments for added security. New Generation BiLock now offers a "Quick Change Core" version (FA2301Q).

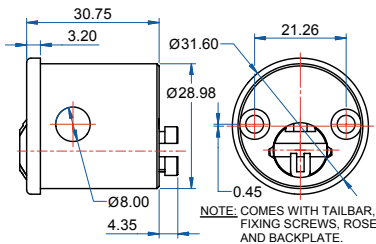

- FA2201 - First Generation
- FA2201Q - First Generation Quick Change Core
- FA2301 - New Generation
- FA2301Q - New Generation Quick Change Core

External cylinder suits most nightlatches including:  
 Lockwood 00 Series, 100 Series, 200 Series, 300 Series  
 Whitco 7000 Series, Efc0 500 Series, Boyd 350 Series  
 Panic Bars using nightlatch cylinders  
 Pack includes tailbar, fixing screws, rose and backplate  
 Lanes P505 & 808; RNC - SK/RCE - 3

SCP CP FB PBU BC

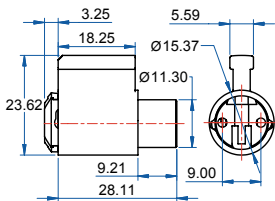

- FA2202 - First Generation
- FA2302 - New Generation

"NOT POSSIBLE IN QCC"

Suits old style Lockwood 001 - internal E Cam not supplied

SCP PBU

### Application

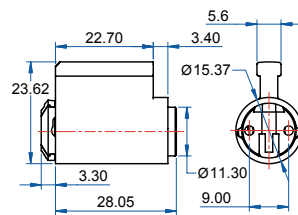

- FA2203 - First Generation
- FA2303 - New Generation

"New Generation" (Please Advise Profile)  
 Suits new style Lockwood 001 - internal E Cam not supplied  
 Suits Lockwood 680 patio bolt when E Cam is modified  
 Suits Lockwood 920 Macquarie 900 series Sliding Door

SCP PBU

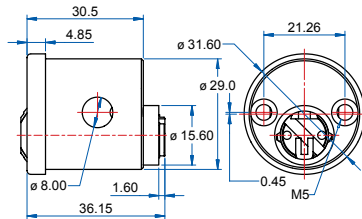

- FA2205 - First Generation
- FA2205Q - First Generation Quick Change Core
- FA2305 - New Generation
- FA2305Q - New Generation Quick Change Core

Suits Lockwood 205 Inner Cylinder  
 Lockwood 255 Inner Cylinder  
 Cams not supplied

SCP PBU

### Typical Uses

- High Security Door Access
- Meter Boxes
- Commercial Buildings
- Industrial Premises
- Perimeter Door Lock
- Household Front and Rear Doors

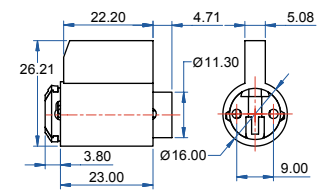

- FA2207 - First Generation
- FA2307 - New Generation

"NOT AVAILABLE IN QUICK CHANGE CORE"

Suits Whitco 7001 Inner Cylinder  
 Cam not supplied

SCP PBU

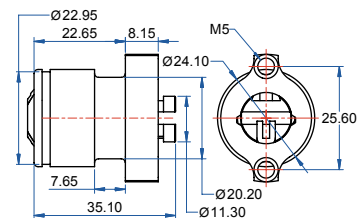

- FA2213 - First Generation
- FA2213Q - First Generation Quick Change Core
- FA2313 - New Generation
- FA2313Q - New Generation Quick Change Core

Suits Abloy 1310 Nightlatch, 1110 Nightlatch External cylinders only. Suits Abloy 2260 cylinder assembly, 2204 cylinder assembly

SCP PBU

Please note, not all product is available (at time of publication) in New Generation. Please check with your nearest BiLock agent or Australian Lock Company.

# BiLock Products

## Rim Lock Cylinders *continued*

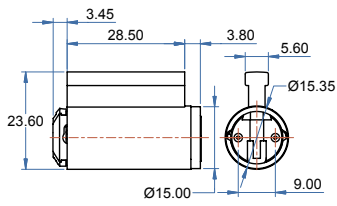

- FA2235 - First Generation
- FA2235Q - First Generation Quick Change Core
- FA2335 - New Generation
- FA2335Q - New Generation Quick Change Core

*Lockwood 355 Deadbolt*

**SCP PBU**

---

Please note, not all product is available (at time of publication) in New Generation. Please check with your nearest BiLock agent or Australian Lock Company.

# BiLock Products

## Camlocks

### Product

New Generation BiLock offers a complete line of high security cam locks available in either standard or "Quick Change Core" (QCC) styles. Camlocks are available in 8 pin and 12 pin versions offering a combination of lengths with a wide variety of key retention and position alternatives.

"CAMS AVAILABLE SEPARATELY"

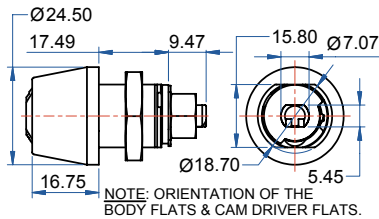

- FA32159 - First Generation - HF
- FA32159Q - First Generation Quick Change Core - VF
- FA33159 - New Generation - HF
- FA33159Q - New Generation Quick Change Core - VF

"New Generation"  
(Please Advise Profile)

5/8" Thread Length Cam Lock  
90 Degrees rotation - key retained

Respectively as above  
FA33151 - 180 Degrees rotation - key retained - HF  
FA32159D - 2 Position key withdrawal 90 Deg - HF  
FA32151B - 2 Position key withdrawal 180 Deg - HF

CP

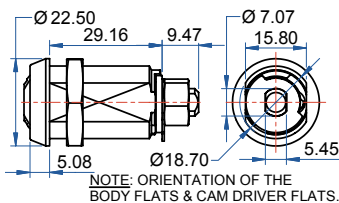

FA32189 - First Generation - VF

1 1/8" Thread Length Cam Lock  
90 Degrees rotation - key retained

Respectively as above  
FA32181 - 180 Degrees rotation - key retained - VF  
FA32189D - 2 Position key withdrawal 90 Deg - VF  
FA32181B - 2 Position key withdrawal 180 Deg - VF/HF

CP

NOTE: HF - Horizontal Flats on body; VF - Vertical Flats on body

### Application



### Typical Uses

- Cash Boxes/Registers
- ATMs
- Parking Meters
- Pay Telephones
- Gaming/Vending Machines
- Access/Alarm Control Systems
- Storage Cabinets

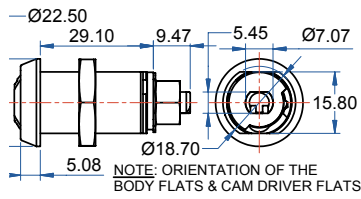

- FA32199 - First Generation - HF
- FA32199Q - First Generation Quick Change Core - VF
- FA33199 - New Generation - HF
- FA33199Q - New Generation Quick Change Core - VF

1 1/8" Thread Length Cam Lock  
90 Degrees rotation - key retained

Respectively as above  
FA32191 - 180 Degrees rotation - key retained - HF  
FA32199D - 2 Position key withdrawal 90 Deg - HF  
FA32191B - 2 Position key withdrawal 180 Deg - HF

CP

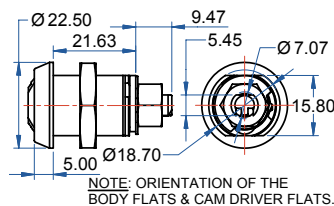

- FA32259 - First Generation - HF
- FA32259Q - First Generation Quick Change Core - VF
- FA33259 - New Generation - HF
- FA33259Q - New Generation Quick Change Core - VF

13/16" Thread Length Cam Lock  
90 Degrees rotation - key retained

Respectively as above  
FA32251 - 180 Degrees rotation - key retained - HF  
FA32259D - 2 Position key withdrawal 90 Deg - HF

CP

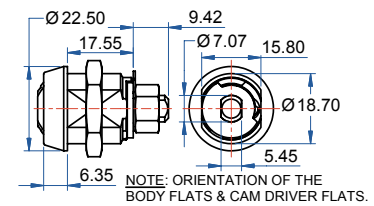

- FA32279 - First Generation - VF
- FA32279Q - First Generation Quick Change Core - VF
- FA33279 - New Generation - VF
- FA33279Q - New Generation Quick Change Core - VF

5/8" Thread Length Cam Lock  
90 Degrees rotation - key retained

Respectively as above  
FA32271 - 180 Degrees rotation - key retained - VF  
FA32279D - 2 Position key withdrawal 90 Deg - VF

CP

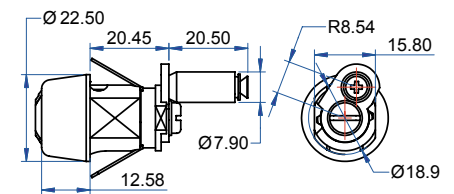

- FA3240 - First Generation - VF
- FA3340 - New Generation - VF

"NOT AVAILABLE IN QUICK CHANGE CORE"  
Filing Cabinet Lock (Complete with cam)

CP

Please note, not all product is available (at time of publication) in New Generation. Please check with your nearest BiLock agent or Australian Lock Company.



## Camlocks *continued*

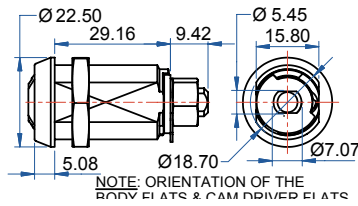

- FA33R19 - New Generation - VF
- FA33R191 - New Generation - VF
- FA32209CP - First Generation
- FA33201CP - New Generation

Respectively as above

FA33R19 - 90 Degrees rotation Asio Camlock

FA33R191 - 180 Degrees rotation Asio Camlock

FA32209CP - Asio equivalent standard camlock 90 Degree, vertical flats

FA33201CP - 180 Degree, vertical flats

CP

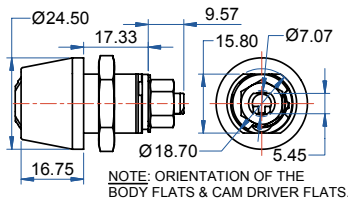

- FA32859 - First Generation - HF
- FA32859Q - First Generation Quick Change Core - VF
- FA33859 - New Generation - HF
- FA33859Q - New Generation Quick Change Core - VF

5/8" Thread Length Cam Lock

90 Degrees rotation - key retained

CP

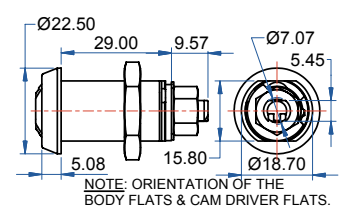

- FA32899 - First Generation - HF
- FA32899Q - First Generation Quick Change Core - VF
- FA33899 - New Generation - HF
- FA33899Q - New Generation Quick Change Core - VF

1 1/8" Thread Length Cam Lock, 8 Pin - Horizontal Flats

90 Degrees rotation - key retained

Respectively as above

FA32899D - 2 Position key withdrawal 90 Deg - HF

CP

### Cam Chart

<p><b>CM32R1514</b></p>	<p><b>No.3 POSITION</b></p>	<p><b>No.12 POSITION</b></p>	<table border="1"> <thead> <tr> <th>CAM No</th> <th>HOLE</th> <th>W</th> <th>Y</th> </tr> </thead> <tbody> <tr> <td>CM301549</td> <td>3</td> <td>27.50</td> <td>36.50</td> </tr> <tr> <td>CM301550</td> <td>12</td> <td>27.50</td> <td>36.50</td> </tr> <tr> <td>CM301555</td> <td>3</td> <td>35.00</td> <td>44.00</td> </tr> <tr> <td>CM301556</td> <td>12</td> <td>35.00</td> <td>44.00</td> </tr> <tr> <td>CM301559</td> <td>3</td> <td>40.00</td> <td>49.00</td> </tr> <tr> <td>CM301560</td> <td>12</td> <td>40.00</td> <td>49.00</td> </tr> <tr> <td>CM301566</td> <td>12</td> <td>47.50</td> <td>56.50</td> </tr> </tbody> </table>	CAM No	HOLE	W	Y	CM301549	3	27.50	36.50	CM301550	12	27.50	36.50	CM301555	3	35.00	44.00	CM301556	12	35.00	44.00	CM301559	3	40.00	49.00	CM301560	12	40.00	49.00	CM301566	12	47.50	56.50				
CAM No	HOLE	W	Y																																				
CM301549	3	27.50	36.50																																				
CM301550	12	27.50	36.50																																				
CM301555	3	35.00	44.00																																				
CM301556	12	35.00	44.00																																				
CM301559	3	40.00	49.00																																				
CM301560	12	40.00	49.00																																				
CM301566	12	47.50	56.50																																				
<p><b>CM301569</b></p>	<p><b>PART No</b></p> <table border="1"> <thead> <tr> <th>PART No</th> <th>CAM</th> <th>Z</th> <th>X</th> </tr> </thead> <tbody> <tr> <td>CM301570</td> <td>A3/A12</td> <td>60.33</td> <td>68.58</td> </tr> <tr> <td>CM301579</td> <td>B3/B12</td> <td>57.15</td> <td>65.40</td> </tr> <tr> <td>CM301575</td> <td>D3/D12</td> <td>50.80</td> <td>59.05</td> </tr> <tr> <td>CM301572</td> <td>E3/E12</td> <td>47.63</td> <td>55.88</td> </tr> <tr> <td>CM301576</td> <td>G3/G12</td> <td>41.28</td> <td>49.53</td> </tr> <tr> <td>CM301574</td> <td>J3/J12</td> <td>31.75</td> <td>40.00</td> </tr> <tr> <td>CM301578</td> <td>K3/K12</td> <td>28.58</td> <td>36.83</td> </tr> <tr> <td>CM301571</td> <td>L3/L12</td> <td>25.40</td> <td>33.65</td> </tr> </tbody> </table>	PART No	CAM	Z	X	CM301570	A3/A12	60.33	68.58	CM301579	B3/B12	57.15	65.40	CM301575	D3/D12	50.80	59.05	CM301572	E3/E12	47.63	55.88	CM301576	G3/G12	41.28	49.53	CM301574	J3/J12	31.75	40.00	CM301578	K3/K12	28.58	36.83	CM301571	L3/L12	25.40	33.65		<p><b>CM301573</b></p>
PART No	CAM	Z	X																																				
CM301570	A3/A12	60.33	68.58																																				
CM301579	B3/B12	57.15	65.40																																				
CM301575	D3/D12	50.80	59.05																																				
CM301572	E3/E12	47.63	55.88																																				
CM301576	G3/G12	41.28	49.53																																				
CM301574	J3/J12	31.75	40.00																																				
CM301578	K3/K12	28.58	36.83																																				
CM301571	L3/L12	25.40	33.65																																				
<p><b>CM301581</b></p>	<p><b>CM32R1604</b></p>	<p><b>CM32R1605</b></p>	<p><b>CM32R1607</b></p>																																				
<p><b>CM32R1608</b></p>	<p><b>CM32R1611</b></p>	<p><b>CM32R19</b></p>																																					

Please note, not all product is available (at time of publication) in New Generation. Please check with your nearest BiLock agent or Australian Lock Company.

## Deadlocks

### Product

New Generation BiLock offers a true high security deadlock range with single sided and double sided key locking deadlock. Again, designed to suit most architectural door hardware, the BiLock high security deadlock is used on doors where key operated deadlocking is required.

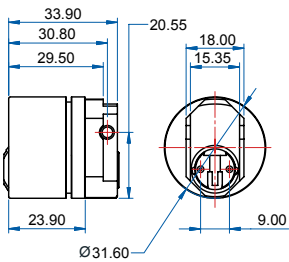

- FA4207 - First Generation
- FA4207Q - First Generation Quick Change Core
- FA4307 - New Generation
- FA4307Q - New Generation Quick Change Core

Lockwood 007/008 Outer

#### SCP PBU

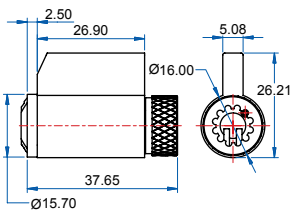

- FAC4261 - First Generation
- FAC4361 - New Generation
- FAC4261Q - First Generation Quick Change Core
- FAC4361Q - New Generation Quick Change Core

Deadbolt - Single Cylinder Only

#### SCP PBU FB

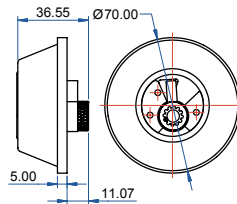

- FA4261 - First Generation
- FA4261Q - First Generation Quick Change Core
- FA4361 - New Generation
- FA4361Q - New Generation Quick Change Core

Single Deadbolt

Suits : Lane, Whitco

#### SCP PBU FB

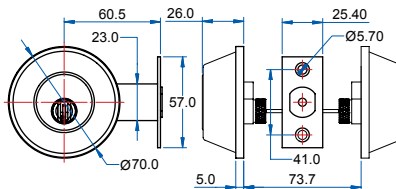

- FA4262 - First Generation
- FA4262Q - First Generation Quick Change Core
- FA4362 - New Generation
- FA4362Q - New Generation Quick Change Core

Double Cylinder

Suits : Lane, Whitco

#### SCP PBU FB

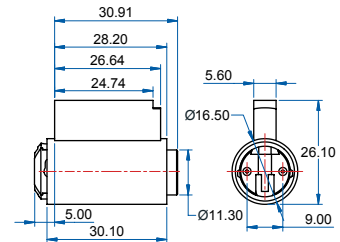

- FA4277 - First Generation - old style
- FA4377 - New Generation - old style
- FA4278 - First Generation - new style
- FA4278Q - First Generation Quick Change Core
- FA4378 - New Generation
- FA4378Q - New Generation Quick Change Core

Lockwood 777

#### SCP PBU

# BiLock Products

## Euro Din Lock Cylinders

### Product

New Generation BiLock offers Euro din cylinders in double cylinder and the thumbturn versions. Australian Security Intelligence Organisation (ASIO) endorsed in its highest category for key operated locks. Chubb 3C10 and 3C20 locks are endorsed when used in specific New Generation BiLock applications. A range of endorsed padlocks, camlocks, switch locks and cylinders as contained in the Government's "Security Equipment Catalogue" are available to government departments.

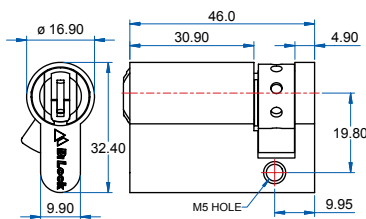

- FA5211Q - First Generation Quick Change Core
- FA5311Q - New Generation Quick Change Core

Single Euro Cylinder (Fixed Cam)  
Suits Chubb 3C10 and most European locks

Respectively as above  
FA53B11Q - ASIO series

#### CP PBU

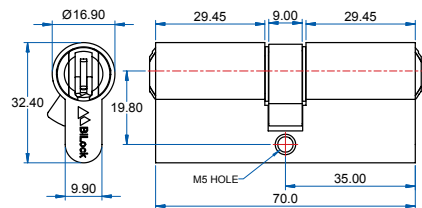

- FA5212Q - First Generation Quick Change Core
- FA5312Q - New Generation Quick Change Core

Double Euro Cylinder - Please advise Profile  
(Fixed Cam)  
Suits Chubb 3C10 and most European locks

Respectively as above  
FA53B12Q - ASIO series

#### CP PBU

### Application



### Typical Uses

Commercial Building Entries and Exit Doors  
Internal Security Grille Doors

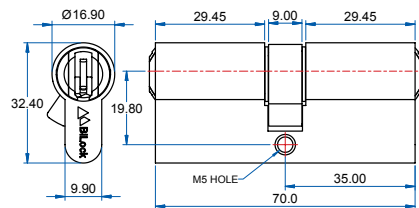

- FA5212FQ - First Generation Quick Change Core
- FA5312FQ - New Generation Quick Change Core

Double Euro Cylinder - Please advise Profile  
(Floating Cam - 180 degree lost motion)  
Suits Whitco 51 Series, Doric DS250, Doric DS245

#### CP PBU

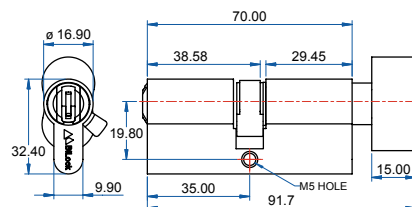

- FA5213Q - First Generation Quick Change Core
- FA5313Q - New Generation Quick Change Core

Thumbturn Euro Cylinder - Please advise Profile  
(Fixed Cam)  
Suits Chubb 3C10 and most European locks

Respectively as above  
FA53B13Q - ASIO series

#### CP PBU

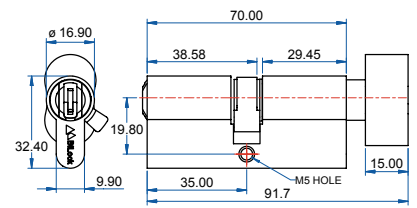

- FA5213FQ - First Generation Quick Change Core
- FA5313FQ - New Generation Quick Change Core

Thumbturn Euro Cylinder - Please advise Profile  
(Floating Cam - 180 degree lost motion)  
Suits Whitco 51 Series, Doric DS250, Doric DS266

#### CP PBU

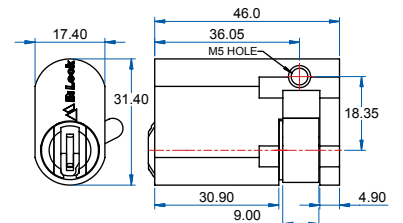

- FA5231Q - First Generation Quick Change Core
- FA5331Q - New Generation Quick Change Core

Single Union Oval Cylinder - Please Advise Profile  
Suits Union models

#### CP PBU

As required in European applications, the cylinder bible is mounted facing downwards and the key barrel is oriented to suit. If barrel is to be mounted as per illustration, key will be upside down. Please note, not all product is available (at time of publication) in New Generation. Please check with your nearest BiLock agent or Australian Lock Company.

Please note, not all product is available (at time of publication) in New Generation. Please check with your nearest BiLock agent or Australian Lock Company.

## Euro Din Lock Cylinders *continued*

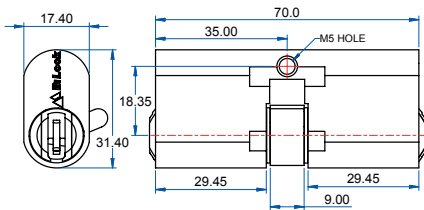

FA5232Q - First Generation Quick Change Core  
 FA5332Q - New Generation Quick Change Core

*Double Union Oval Cylinder - Please Advise Profile  
 Suits Union models*

**CP PBU**

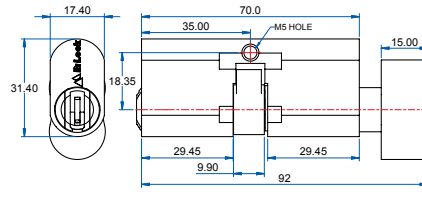

FA5233Q - First Generation Quick Change Core  
 FA5333Q - New Generation Quick Change Core

*Thumbturn Union Oval Cylinder - Please Advise Profile  
 Suits Union models*

**CP PBU**

Please note, not all product is available (at time of publication) in New Generation. Please check with your nearest BiLock agent or Australian Lock Company.

# BiLock Products

## Mortice Lock Cylinders

### Product

New Generation BiLock offers a full range of mortice lock cylinders, which allow key access from both sides of the lock. The mortice cylinders are designed to suit most international door hardware and associated locks. These cylinder assemblies can be supplied in a variety of attractive finishes to match your choice of locksets or to suit existing locks.

### Application



### Typical Uses

Commercial Building Entries and Exit Doors  
Internal Security Doors

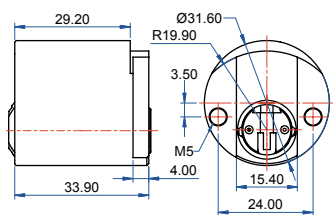

- FA5201 - First Generation
- FA5201Q - First Generation Quick Change Core
- FA5301 - New Generation
- FA5301Q - New Generation Quick Change Core

Lockwood DKO  
Digital Override

#### SCP PBU

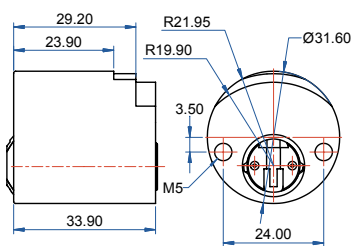

- FA5202 - First Generation
- FA5202Q - First Generation Quick Change Core
- FA5302 - New Generation
- FA5302Q - New Generation Quick Change Core

Lockwood DKO - New Style

#### SCP PBU

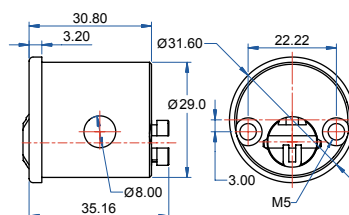

- FA5210 - First Generation
- FA5310 - New Generation

Suits Efc0 510 and Etas Mortice Nightlatch with In-line screw fixing

#### SCP PBU

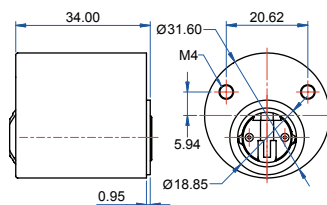

- FA5230 - First Generation
- FA5330 - New Generation

Lane Astra Bayonet  
(With Bayonet Fitting)

#### SCP PBU

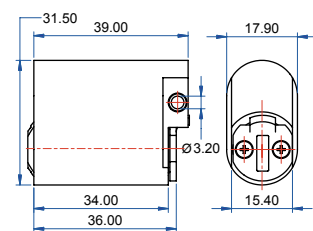

- FA5235 - First Generation
- FA5235Q - First Generation Quick Change Core
- FA5335 - New Generation
- FA5335Q - New Generation Quick Change Core

Lane Astra (O.C Series)

#### SCP CP FB PBU BC

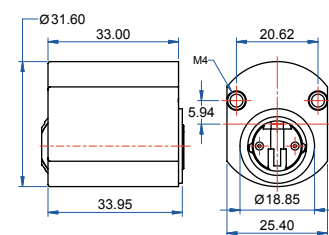

- FA5237 - First Generation
- FA5337 - New Generation

Lane Astra Bayonet  
(Flat Sided with Bayonet fitting)

#### SCP PBU

Please note, not all product is available (at time of publication) in New Generation. Please check with your nearest BiLock agent or Australian Lock Company.

## Mortice Lock Cylinders *continued*

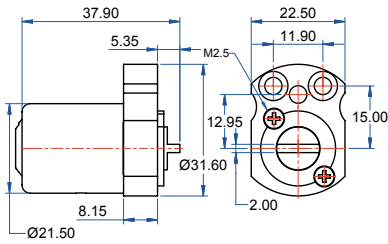

- FA5257 - First Generation
- FA5257Q - First Generation Quick Change Core
- FA5357 - New Generation
- FA5357Q - New Generation Quick Change Core

Abloy Mortice  
(Spring Loaded Driver & Tapped Holes)

### SCP PBU

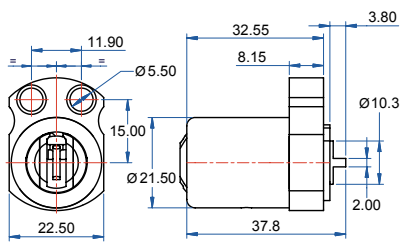

- FA5258 - First Generation
- FA5258Q - First Generation Quick Change Core
- FA5358 - New Generation
- FA5358Q - New Generation Quick Change Core

Abloy Mortice  
(Spring Loaded Driver)

### SCP PBU

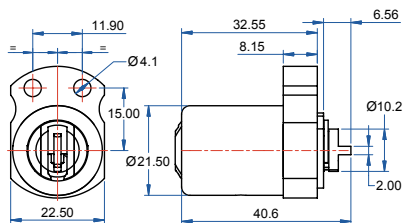

- FA5259 - First Generation
- FA5259Q - First Generation Quick Change Core
- FA5359 - New Generation
- FA5359Q - New Generation Quick Change Core

Abloy Mortice  
(Fixed Driver)

### SCP PBU

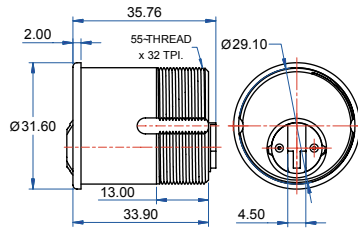

- FA5260 - First Generation
- FA5260Q - First Generation Quick Change Core
- FA5360 - New Generation
- FA5360Q - New Generation Quick Change Core

Adams Rite/Kawneer

### SCP PBU

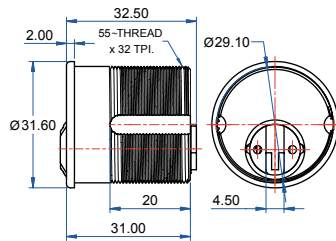

- FA5261 - First Generation
- FA5261Q - First Generation Quick Change Core
- FA5361 - New Generation
- FA5361Q - New Generation Quick Change Core

Adams Rite/Kawneer

### SCP PBU

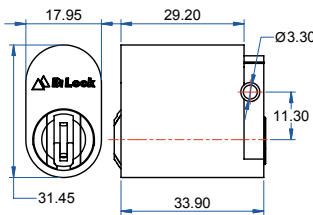

- FA5290 - First Generation
- FA5290Q - First Generation Quick Change Core
- FA5390 - New Generation
- FA5390Q - New Generation Quick Change Core

Alcom 5000 Series Mortice Lock  
Oval Cylinder  
Boyd, Gainsborough  
Lockwood, Lane, Legge Schlage

### SCP CP FB PBU BC

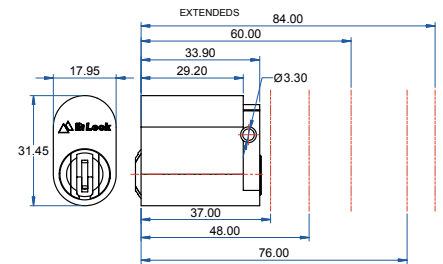

- FA529037 - First Generation
- FA529037Q - First Generation Quick Change Core
- FA539037 - New Generation
- FA539037Q - New Generation Quick Change Core

Also available in 48cm; 60cm; 76cm; 76cm & 84cm  
(eg: FA529048)

Alcom 5000 Series Mortice Lock, Oval Extended Cylinder  
Boyd, Gainsborough, Lockwood, Lane, Legge Schlage

### SCP PBU

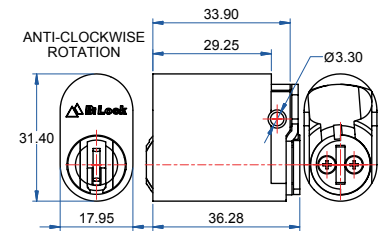

- FA5293L - First Generation
- FA5293LQ - First Generation Quick Change Core
- FA5393L - New Generation
- FA5393LQ - New Generation Quick Change Core

Alcom 5000 Series, Mortice Lock  
Holdback LH or RH Turn  
(Complete with Holdback Cam)

### SCP CP FB PBU

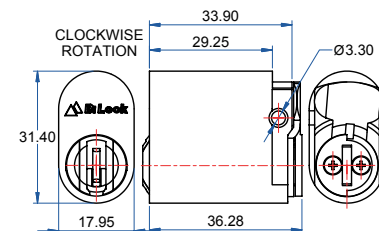

- FA5293R - First Generation
- FA5293RQ - First Generation Quick Change Core
- FA5393R - New Generation
- FA5393RQ - New Generation Quick Change Core

Alcom 5000 Series, Mortice Lock  
Holdback LH or RH Turn  
(Complete with Holdback Cam)

### SCP CP FB PBU

Please note, not all product is available (at time of publication) in New Generation. Please check with your nearest BiLock agent or Australian Lock Company.

# BiLock Products

## Padlocks

### Product

The BiLock hardened steel padlock offers multiple features, not least of which is a competitive price that should see it quickly established as a market leader.

Features include:

- A protective polyurethane cushion which offers protection from other surfaces contacting the padlock.

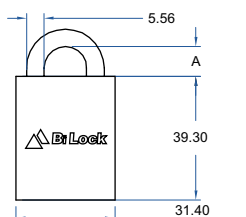

FA6232 - First Generation  
FA6332 - New Generation

"NOT AVAILABLE IN QCC"

Small Brass Padlock

DIMENSION A

13mm Shackle - S

25mm Shackle - SA

38mm Shackle - SAA

Less Shackle - LS

### Brass

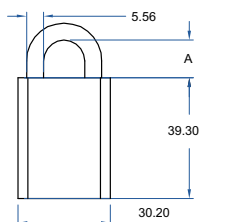

First Generation

FA6235BLKBAA - Black

FA6235REDBAA - Red

FA6235WHITBAA - White

FA6235BLUEBAA - Blue

FA6235GRNBAA - Green

FA6235LILBAA - Lilac

FA6235YELLBAA - Yellow

FA6235ORANBAA - Orange

New Generation

FA6335BLKBAA - Black

FA6335REDBAA - Red

FA6335WHITBAA - White

FA6335BLUEBAA - Blue

FA6335GRNBAA - Green

FA6335LILBAA - Lilac

FA6335YELLBAA - Yellow

FA6335ORANBAA - Orange

BAA shackle [38mm brass AA] only. Key retained version only. Used extensively on mining sites to isolate equipment and reduce the risk of sparks.

All colours are available less shackle [LS replaces BAA in product code above].

"NOT AVAILABLE IN QCC"

### Delrin Plastic

- A Molybdenum shackle which is a super tough alloy steel for added protection.
- The BiLock padlock comes complete with cylinder or without cylinder.
- Marine grade - C6
- Hardened steel body.

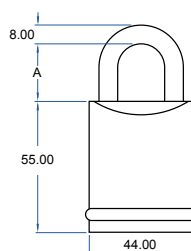

FA6244 - First Generation  
FA6244Q - First Generation Quick Change Core  
FA6344 - New Generation  
FA6344Q - New Generation Quick Change Core

44mm snap shut/key retained Padlock. Padlock takes a FAC6244 cylinder. Shackle material is molybdenum which is a super tough alloy steel. Satin nickel finish.

Dimension A

25mm Shackle - S

50mm Shackle - SA

75mm Shackle - SAA

Pack contains a cam which converts the padlock to both snap shut or key retained.

### Satin Nickel Finish

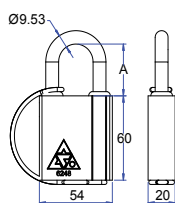

Shackle height (dimension 'A') is available in 37.85, 58 & 88mm

FA6248 - First Generation

FA6248Q - First Generation Quick Change Core

FA6348 - New Generation

FA6348Q - New Generation Quick Change Core

Water/Dust Resistant

DIMENSION A

37.85mm Stainless Shackle - SS

58mm Stainless Shackle - SSA

88mm Stainless Shackle - SSAA

### Brass

### Typical Uses

- Perimeter Gates
- Vehicles
- Vending Machines
- Industrial Safe Keeping
- Higher Security Areas/Buildings

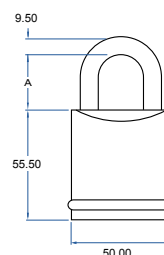

FA6250 - First Generation  
FA6250Q - First Generation Quick Change Core  
FA6350 - New Generation  
FA6350Q - New Generation Quick Change Core

50mm snap shut/key retained Padlock. Padlock takes a FAC6244 cylinder. Shackle material is molybdenum which is a super tough alloy steel.

Dimension A

25mm Shackle - S

50mm Shackle - SA

75mm Shackle - SAA

Pack contains a cam which converts the padlock to both snap shut or key retained.

### Satin Nickel Finish

Please note, not all product is available (at time of publication) in New Generation. Please check with your nearest BiLock agent or Australian Lock Company.

Please note, not all product is available (at time of publication) in New Generation. Please check with your nearest BiLock agent or Australian Lock Company.

## Padlocks *continued*

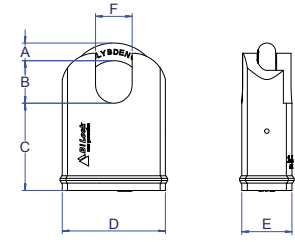

Part No.	A	B	C	D	E	F
FA6361S	9.5	27.0	55.5	50.0	30.0	21.0
FA6261S	9.5	27.0	55.5	50.0	30.0	21.0
FA6361S	11.0	27.0	60.0	60.1	32.0	23.0
FA6261S	11.0	27.0	60.0	60.1	32.0	23.0

### 50mm Shackle Protected Padlock

- FA6251S - First Generation
- FA6351S - New Generation

### 60mm Shackle Protected Padlock

- FA6261S - First Generation
- FA6361S - New Generation

Only available in 25mm shackle

### Hardened Steel Shackle Protected Padlock

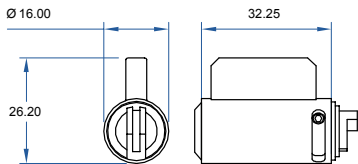

- FA6220 - First Generation
  - FA6220Q - First Generation Quick Change Core
  - FA6320 - New Generation
  - FA6320Q - New Generation Quick Change Core
- Master Pro Cylinder

### Satin Chrome Plate Cylinder Finish Only

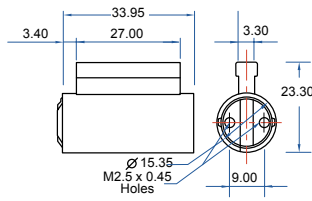

- FA6236 - First Generation
- FA6236Q - First Generation Quick Change Core
- FA6336 - New Generation
- FA6336Q - New Generation Quick Change Core

### 234B45 Lockwood Padlock Cylinder

### Satin Chrome Plate, Natural Brass

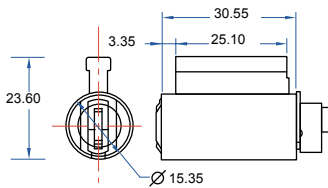

### Cylinder Only

- FAC6244 - First Generation
- FAC6244Q - First Generation Quick Change Core
- FAC6344 - New Generation
- FAC6344Q - New Generation Quick Change Core

### Satin Chrome Plate, Natural Brass

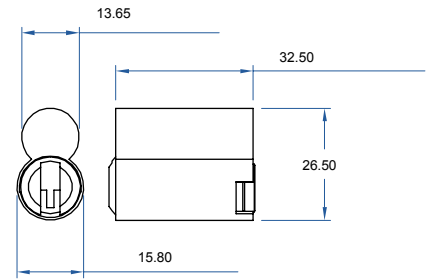

### Abus Padlock Cylinder Only

- FA6283PB - First Generation
- FA6383PB - New Generation
- FA6283QPB - First Generation Quick Change Core
- FA6383QPB - New Generation Quick Change Core
- FA6283SC - First Generation
- FA6383SC - New Generation
- FA6283QSC - First Generation Quick Change Core
- FA6383QSC - New Generation Quick Change Core

### Satin Chrome Plate, Natural Brass

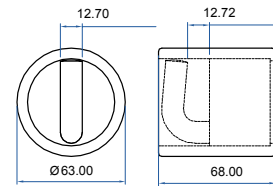

### FA6260 - First Generation

"NOT AVAILABLE IN QCC"

Respectively as above

FA62R6OSS - Lokgard Padlock Asia series

Lokgard Padlock

14.5mm Stainless Shackle - SS

### Heavy Duty Lokgard Solid Stainless Steel



# BiLock Products

## Padlocks *continued*

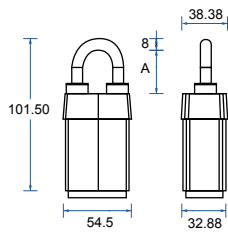

(Complete with cylinder)

- FA6621SC W 54mm, D 8mm, H 28mm
- FA6621LJSC W 54mm, D 8mm, H 35mm
- QCC
- FA6621QSC W 54mm, D 8mm, H 28mm
- FA6621LJQSC W 54mm, D 8mm, H 35mm

### Master Pro Padlock Range

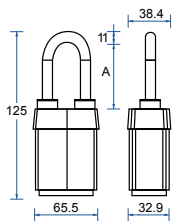

(Complete with cylinder)

- FA6627SC W 67mm, D 11mm, H 35mm
- FA6627LJSC W 67mm, D 11mm, H 48mm
- QCC
- FA6627QSC W 67mm, D 11mm, H 35mm
- FA6627LJQSC W 67mm, D 11mm, H 48mm

### Master Pro Weather Tough Padlock

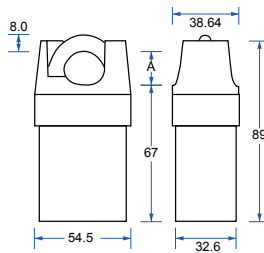

(Complete with cylinder)

- FA6721SC W 54mm, D 8mm, H 19mm
- FA6727LJSC W 67mm, D 11mm, H 19mm
- QCC
- FA6721QSC W 54mm, D 8mm, H 19mm
- FA6727LJQSC W 67mm, D 11mm, H 19mm c info

### Shrouded Shackle Padlock

Please note, not all product is available (at time of publication) in New Generation. Please check with your nearest BiLock agent or Australian Lock Company.

## Switch Locks

### Product

New Generation BiLock offers a complete line of integrated and modular high security switch locks designed to adapt to a wide range of switching, voltage and current requirements. Combining New Generation BiLock security with a commercial micro switch provides a wide variety of electric switching operations for individual needs.

Special purpose switching applications can also be supplied to order in consultation with Head Office.



### Typical Uses

- |                   |                    |
|-------------------|--------------------|
| Gaming Equipment  | Flood Lighting     |
| Alarm Systems     | Security Lighting  |
| Automatic Doors   | Computer Equipment |
| Boom Gates        | Safety Switches    |
| Elevators         | Escalators         |
| Electric Vehicles |                    |

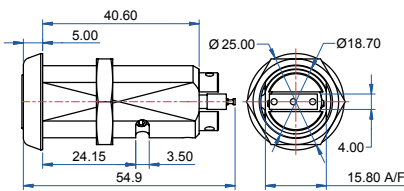

FA8210 - First Generation - VF  
Integrated Key Switchlock - 12 Pin  
On/Off Single Pole Spring Return

FA8220 - First Generation - VF  
Integrated Key Switchlock - 12 Pin  
On/Off 2 Position Key Withdrawal

FA8240 - First Generation - VF  
Integrated Key Switchlock - 12 Pin  
On/Off 1 Position Key Withdrawal  
Switch Details: 4amp@28vdc;7amp@250vac

CP

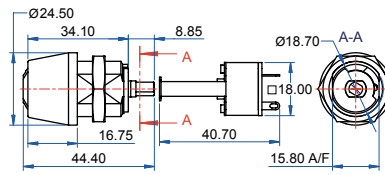

FA82259 - First Generation - VF  
FA82259Q - First Generation Quick Change Core - VF  
FA83259 - New Generation - VF  
FA83259Q - New Generation Quick Change Core - VF

Modular Key Switchlock - 12 Pin  
On/Off 90 Degrees Rotation  
Respectively as above

FA82259D - On/Off 2 Position Key Withdrawal - VF  
FA82351 - On/Off/On 1 Pole 180 Deg Rotation - VF  
FA82552 - On/Off/On 2 Pole 120 Deg - VF

Switch Detail

90 degrees rotation 2amp@250vac;10amp@12vdc  
180 degrees rotation 0.4va maximum@20vac or vdc  
120 degrees rotation 0.4va maximum@20vac or vdc

CP

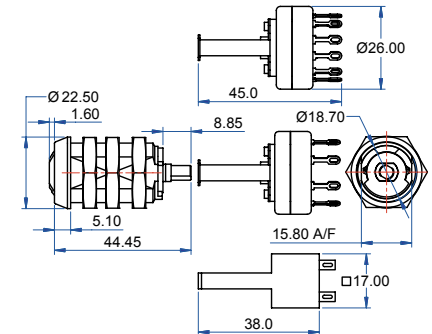

FA83391Q (Shown)

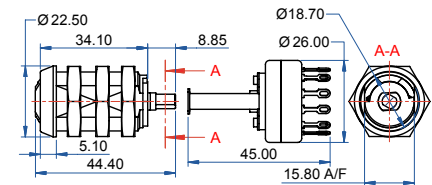

FA83952Q (Shown)

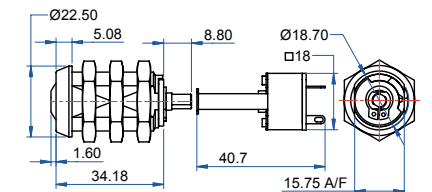

FA82299 - First Generation - VF  
FA82299Q - First Generation Quick Change Core - VF  
FA83299 - New Generation - VF  
FA83299Q - New Generation Quick Change Core - VF

Modular Key Switchlock - 12 Pin  
On/Off 90 Degrees Rotation - 1 Pole  
Respectively as above

FA82299D - On/Off 1 Pole, 90 Deg 2 Position Key W/D - VF  
FA83391Q - On/Off/On 1 Pole 180 Deg Key W/D Off  
FA83592Q - On/Off/On 2 Pole 120 Degree rotation

CP

## Switch Locks *continued*

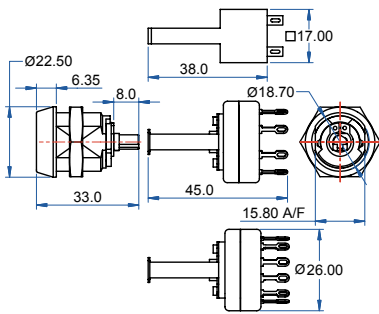

FA82361 (Shown)

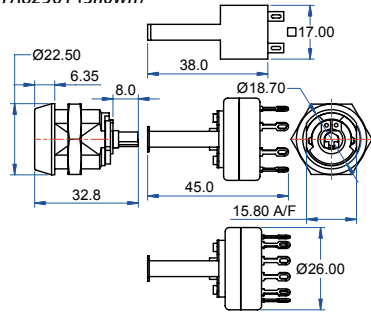

FA82562 (Shown)

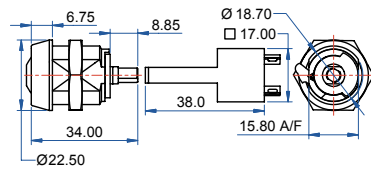

- FA82269 - First Generation - VF
- FA82269Q - First Generation Quick Change Core - VF
- FA83269 - New Generation - N/A - VF
- FA83269Q - New Generation Quick Change Core - VF

**Modular Key Switchlock - 8 Pin**  
On/Off 1 Pole, 90 Degrees Rotation

Respectively as above  
FA82361 - On/Off/On 1 Pole, 3 Pos Key W/D 180 Deg - VF  
FA82562 - On/Off/On 2 Pole 3 Pos Key W/D Off 120 Deg - VF

**Switch Detail**

90 degrees rotation      2amp@250vac:10amp@12vdc  
180 degrees rotation    0.4va maximum@20vac or vdc  
120 degrees rotation    0.4va maximum@20vac or vdc

CP

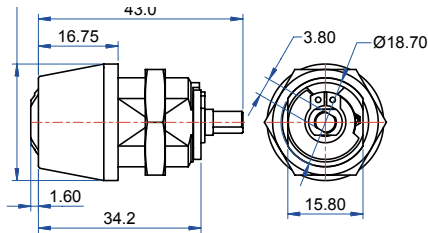

- A82059 - First Generation - VF
- FA82059Q - First Generation Quick Change Core - VF
- FA83059 - New Generation - VF
- FA83059Q - New Generation Quick Change Core - VF

**Modular Switchlock - 12 Pin**  
Without Switch  
90 Deg Key W/D in Off Position

Respectively as above  
FA82059D - 90 Deg Key W/D in Both Positions  
FA82051 - 180 Deg Key W/D in Centre Position

CP

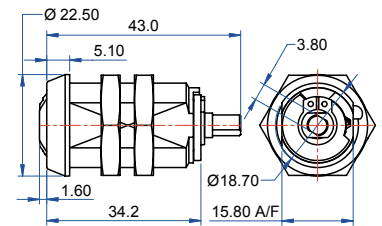

- FA82099 - First Generation - VF
- FA82099Q - First Generation Quick Change Core - VF
- FA83099 - New Generation - VF
- FA83099Q - New Generation Quick Change Core - VF

**Modular Switchlock - 12 Pin**  
Without Switch  
90 Deg Key W/D in Off Position

Respectively as above  
FA82099D - 90 Deg Key W/D in Both Positions - VF  
FA82091 - 180 Deg Key W/D in Centre Position - VF

CP

# BiLock Products

## Key In Knob/ Lever Lockset Cylinders

### Product

New Generation BiLock offers a range of key in knob lock cylinders to suit almost any key in knob hardware including Schlage, Boyd, Efcó, Lane, Whitco and Lockwood. Can be key controlled from both sides of the door or press button lock internally with key controlled locking externally.

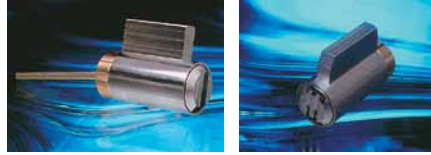

### Typical Uses

- Households
- Commercial Offices
- Storage Rooms
- Limited Access Areas
- Privacy Areas
- Change Rooms
- Offices

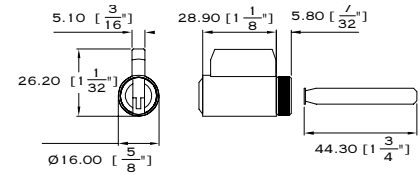
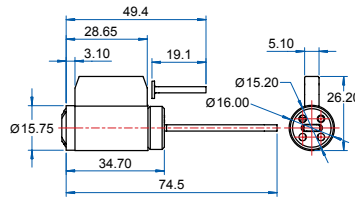
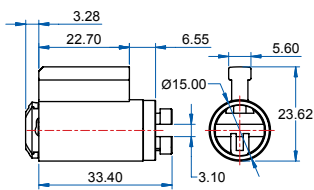

- FA9316 - New Generation
- FA9316Q - New Generation Quick Change Core

- FA9220L - First Generation
- FA9220Q - First Generation Quick Change Core
- FA9320L - New Generation
- FA9320Q - New Generation Quick Change Core

- FA9222L - First Generation
- FA9222Q - First Generation Quick Change Core
- FA9322L - New Generation
- FA9322Q - New Generation Quick Change Core

Lockwood Macquarie 9000 outer

Boyd D&H Series (Long Tail) Schlage  
PD Series

Suits B162P, 12Z, B462P, B828P & Schlage  
Boyd B series (long tail bar)

SCP PBU

SCP PBU

SCP PBU

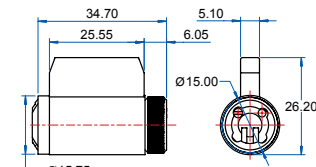
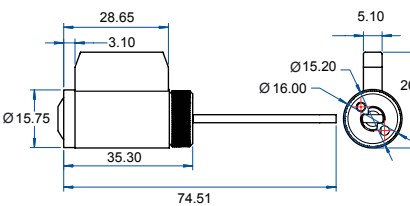
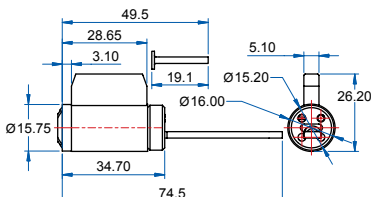

- FA9220 - First Generation
- FA9220Q - First Generation Quick Change Core
- FA9320 - New Generation
- FA9320Q - New Generation Quick Change Core

- FA9222 - First Generation
- FA9222Q - First Generation Quick Change Core
- FA9322 - New Generation
- FA9322Q - New Generation Quick Change Core

- FA9224 - First Generation
- FA9224Q - First Generation Quick Change Core
- FA9324 - New Generation
- FA9324Q - New Generation Quick Change Core

Boyd A Series - 6 Pin Only  
Plymouth & Novo Only  
& Schlage; Carbine (use existing tailpiece)  
Boyd A Series (Short Tail Piece)  
Century & Tulip  
Schlage  
PD Series

Boyd  
B162P, 12Z, B462P, B862P & Schlage; Boyd B Series

Suits Carbine Deadbolt 4000 series & Carbine Ilco 3000 series (Less tail bar)

SCP PBU

SCP PBU

SCP PBU

Please note, not all product is available (at time of publication) in New Generation. Please check with your nearest BiLock agent or Australian Lock Company.

## Key In Knob/ Lever Lockset Cylinders *continued*

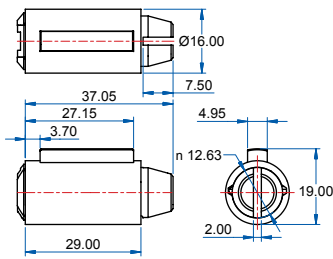

- FA9230 - First Generation
- FA9230Q - First Generation Quick Change Core
- FA9330 - New Generation
- FA9330Q - New Generation Quick Change Core

EFCO "J" Series

SCP PBU

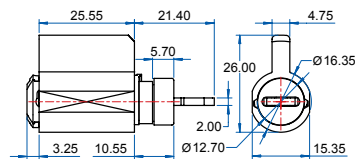

- FA9231 - First Generation
- FA9231Q - First Generation Quick Change Core
- FA9331 - New Generation
- FA9331Q - New Generation Quick Change Core

Lane Apollo Entrance - Old Style  
Lane Apollo Classroom - Old Style

SCP PBU

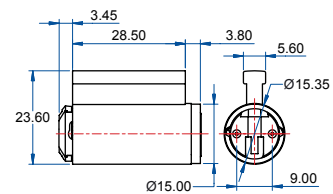

- FA9235 - First Generation
- FA9235Q - First Generation Quick Change Core
- FA9335 - New Generation
- FA9335Q - New Generation Quick Change Core

Lockwood 355 Deadbolt

SCP PBU

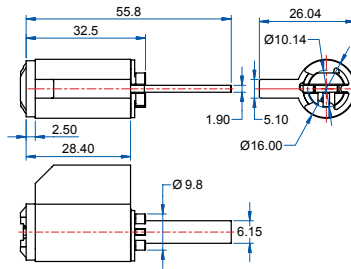

- FA9241 - First Generation
- FA9341 - New Generation

Whitco Neptune Lever

CP PBU

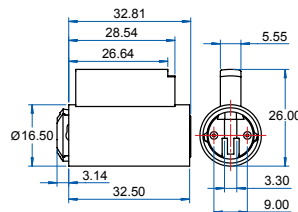

- FA9250 - First Generation
- FA9250Q - First Generation Quick Change Core
- FA9350 - New Generation
- FA9350Q - New Generation Quick Change Core

Lockwood 500

SCP PBU

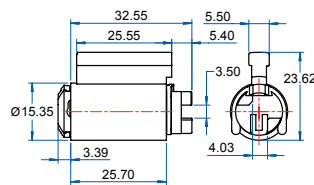

- FA9253 - First Generation
- FA9253Q - First Generation Quick Change Core
- FA9353 - New Generation
- FA9353Q - New Generation Quick Change Core

Lockwood 530

SCP PBU

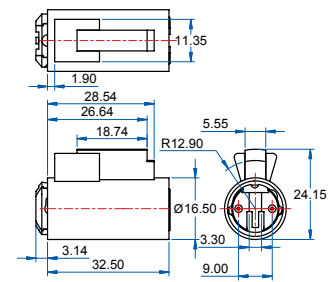

- FA9257 - First Generation
- FA9357 - New Generation

Lockwood 500 V7

SCP PBU

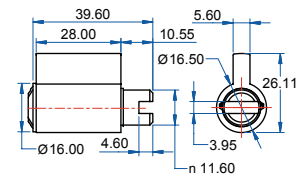

- FA9260 - First Generation
- FA9260Q - First Generation Quick Change Core
- FA9360 - New Generation
- FA9360Q - New Generation Quick Change Core

Suits Lane Corbin Series, Corbin Russwin Series

SCP FB PBU

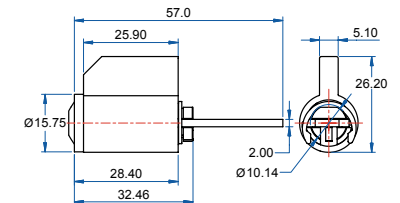

- FA9280 - First Generation
- FA9380 - New Generation

Whitco Key In Knob

CP PBU

## Sliding Door Lock Cylinders

### Product

New Generation BiLock offers high security lock cylinders designed to suit most sliding door hardware. The cylinder offers the end user a range of product enhancements which include pulling, drilling and manipulation resistance to resist forced entry.

### Application



### Typical Uses

Residential Properties  
Commercial Sliding Doors

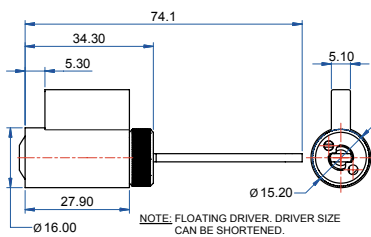

- FA9262 - First Generation
- FA9362 - New Generation

*Whitco Outer*  
Suits : Forrest, Mitchell  
Napier, Oxley

CP PBU

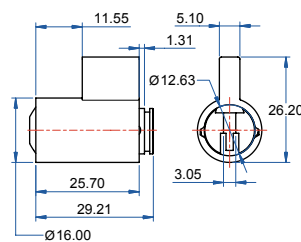

- FA9264 - First Generation
- FA9364 - New Generation

*Whitco Inner*  
Suits : Sturt, Forrest

CP PBU

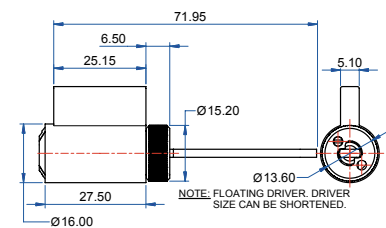

- FA9266 - First Generation
- FA9366 - New Generation

*Whitco Blaxland Outer*

CP PBU

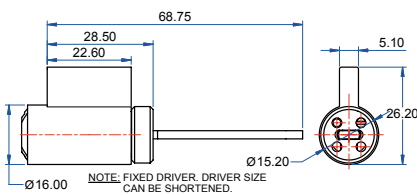

- FA9263 - First Generation
- FA9363 - New Generation

*Whitco Outer*  
Suits : Sturt

CP PBU

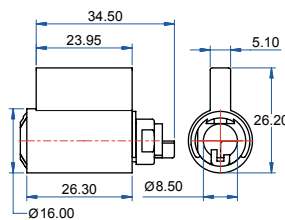

- FA9265 - First Generation
- FA9365 - New Generation

*All Whitco Blaxland Inner spec info*

CP PBU

Please note, not all product is available (at time of publication) in New Generation. Please check with your nearest BiLock agent or Australian Lock Company.

# BiLock Products

## Supplementary Products

### Product

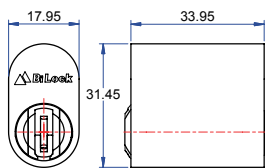

"NOT AVAILABLE IN QUICK CHANGE CORE"

- FA7294 - First Generation
- FA7294Q - First Generation Quick Change Core
- FA7394 - New Generation
- FA7394Q - New Generation Quick Change Core

Orb Cupboard Oval Cylinder

SCP PBU

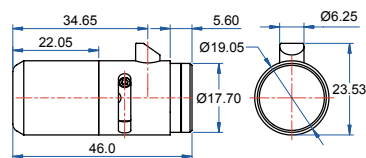

"NOT AVAILABLE IN QUICK CHANGE CORE"

- FA7210 - First Generation

"T" Handle Vending Lock (Latching)

CP

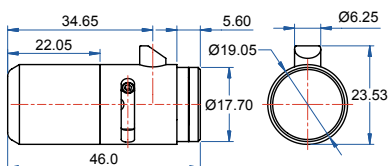

"NOT AVAILABLE IN QUICK CHANGE CORE"

- FA7212 - First Generation

Vending Lock (Dead Latching)

CP

### Typical Uses

- |                 |              |
|-----------------|--------------|
| Cash Drawers    | Key Cabinets |
| Safe Treasuries | Alarm Panels |
| Switch Panels   | Meter Boxes  |
| Drug Cabinets   | Lockers      |

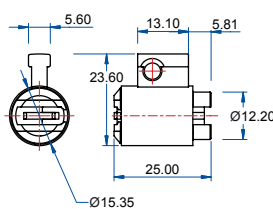

"NOT AVAILABLE IN QUICK CHANGE CORE"

- FA7223 - First Generation
- FA7323 - New Generation

Roller Door Cylinder Only

(Single sided operation/possible double sided operation)

CP

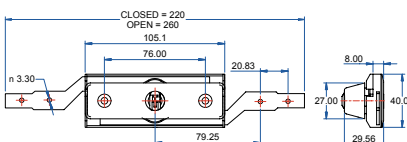

"NOT AVAILABLE IN QUICK CHANGE CORE"

- FA7225 - First Generation
- FA7325 - New Generation

Lock Focus Garage Door Lock

CP

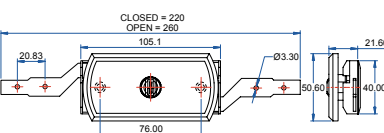

"NOT AVAILABLE IN QUICK CHANGE CORE"

- FA7226 - First Generation
- FA7326 - New Generation

Lock Focus B&D – Roller Door Lock (Single Broach)

CP

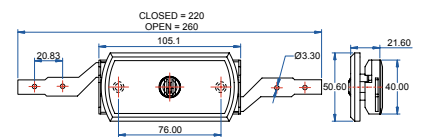

"NOT AVAILABLE IN QUICK CHANGE CORE"

- FA7227 - First Generation
- FA7327 - New Generation

Lock Focus B&D – Roller Door Lock (Double Broach, key withdrawal in 90° position)

CP

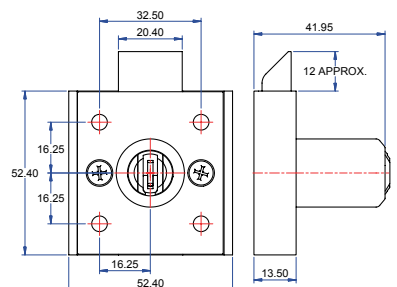

- FA7252 - First Generation
- FA7252Q - First Generation Quick Change Core
- FA7352 - New Generation
- FA7352Q - New Generation Quick Change Core

Cupboard/Drawer Lock

(Dead Latching; Key Retained In Unlocked Position)

CP PBU

Please note, not all product is available (at time of publication) in New Generation. Please check with your nearest BiLock agent or Australian Lock Company.

# BiLock Products

## Supplementary Products *continued*

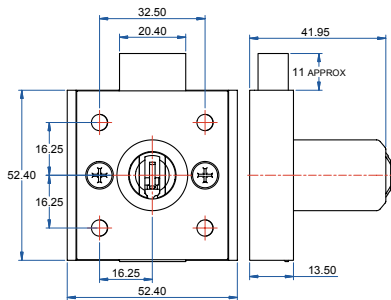

- FA7253 - First Generation
- FA7253Q - First Generation Quick Change Core
- FA7353 - New Generation
- FA7353Q - New Generation Quick Change Core

Cupboard/Drawer Lock  
(Deadlock - Non Key Retained)

### CP PBU

- FA7254 - First Generation
- FA7354 - New Generation

Cupboard/Drawer Lock  
(Latching function only but can be deadlatched by withdrawing the key in one o'clock position.  
Not available in QCC)

### CP PBU

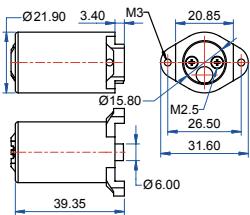

- FA7355 - First Generation
- FA7355Q - First Generation Quick Change Core
- FA7355 - New Generation
- FA7355Q - New Generation Quick Change Core

### CP

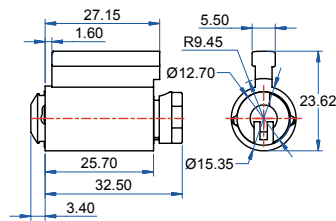

- FA7274 - First Generation
- FA7274Q - First Generation Quick Change Core
- FA7374 - New Generation
- FA7374Q - New Generation Quick Change Core

Lockwood 8474  
Garage Door Lock Cylinder

### CP

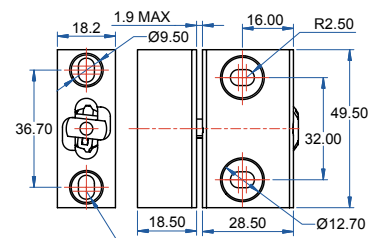

- FA7265DCP - First Generation

Fridge Lock, Double Broach, 90 degrees

### CP



- FA7276 - First Generation
- FA7276Q - First Generation Quick Change Core
- FA7376 - New Generation
- FA7376Q - New Generation Quick Change Core

Suits Lenlock Garage Door, complete with FA9253 cylinder

### SCP

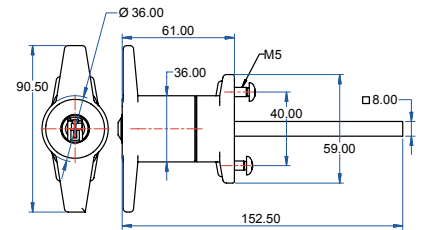

- FA7278 - First Generation
- FA7278Q - First Generation Quick Change Core
- FA7378 - New Generation
- FA7378Q - New Generation Quick Change Core

Suits Lenlock 8474 Garage Door, complete with FA9253 cylinder

### SCP

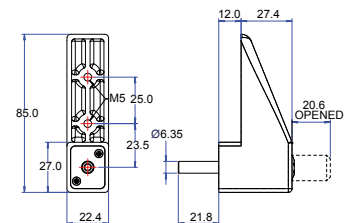

- FA7287 - First Generation
- FA7287Q - First Generation Quick Change Core
- FA7387 - New Generation
- FA7387Q - New Generation Quick Change Core

Showcase Lock

### SCP CP BLK

Please note, not all product is available (at time of publication) in New Generation. Please check with your nearest BiLock agent or Australian Lock Company.



## Supplementary Products *continued*

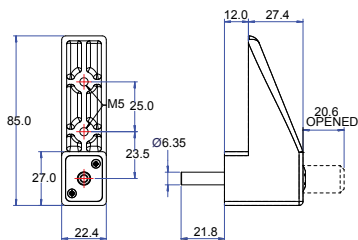

- FA7287D - First Generation
- FA7287DQ - First Generation Quick Change Core
- FA7387D - New Generation
- FA7387DQ - New Generation Quick Change Core

Showcase Lock  
(Key Withdrawal 2 Positions)

### SCP CP BLK

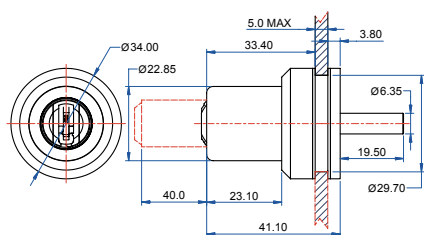

- FA7288 - First Generation
- FA7288Q - First Generation Quick Change Core
- FA7388 - New Generation
- FA7388Q - New Generation Quick Change Core

Thru-Glass Pushlock

### CP PBU

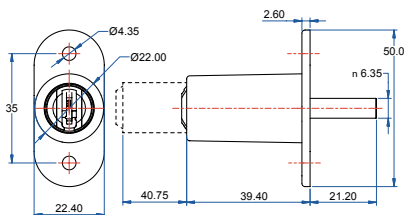

- FA7289 - First Generation
- FA7289Q - First Generation Quick Change Core
- FA7389 - New Generation
- FA7389Q - New Generation Quick Change Core

Pushlock

### CP

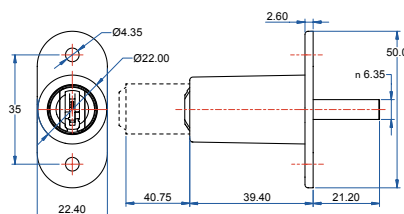

- FA7289D - First Generation
- FA7289DQ - First Generation Quick Change Core
- FA7389D - New Generation
- FA7389DQ - New Generation Quick Change Core

Pushlock  
(Key Withdrawal 2 Positions)

### CP

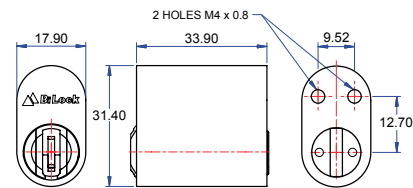

- FA7294 - First Generation
- FA7294Q - First Generation Quick Change Core
- FA7394 - New Generation
- FA7394Q - New Generation Quick Change Core

ORB Cupboard Lock

### SCP, PBU

# Product Warranty

## BiLock High Security Master Key System

Australian Lock Company guarantees its range of BiLock High Security Cylinders & Keys against defects in workmanship & materials. Should the product be found to be defective within its normal working life, Australian Lock Company will repair or replace the product with the same or equivalent product free of charge upon receipt of proof of purchase.

Under this product warranty Australian Lock Company assumes no responsibility for the following:

1. Failure to adhere to fitting instructions or faulty installation.
2. Product wear & tear due to improper maintenance.
3. Product failure caused by the use of non BiLock parts.
4. Unauthorised modifications or repairs made to the product.
5. Use of unauthorised replacement parts.
6. Any costs incurred due to –
  - i) Removal & or replacement of the BiLock product.
  - ii) Freight & / or travelling time.
  - iii) Any modifications or repairs to the BiLock product unless authorised by Australian Lock Company.
7. Personal injury, property damage or economic loss however caused.
8. Damage caused by corrosion when the BiLock product is installed in a corrosive environment.

Nothing in this Australian Lock Company product warranty excludes restricts or modifies in any condition, warranty, right or liability implied or protected by law where to do so would render the guarantee or any part of it void.



Whilst the Australian Lock Company Pty Ltd has taken every effort to ensure that the information in this catalogue is accurate at the time of publication, we recommend that you consult your Sales Representative to ascertain information in specific products and specifications prior to placing your order. Please note that we reserve the right to make changes without notice. The Australian Lock Company Pty Ltd will not be liable for any damage or loss arising from any errors or omissions in the information contained in this catalogue or arising from the use of the information contained herein.

**Australian Lock Company Pty Limited**  
**ABN 17 002 420 840**

### AUSTRALIA

**17 Doyle Avenue, Unanderra NSW**  
**2526 Australia**  
**PO Box 479 Unanderra NSW 2526**  
**Australia**  
**Ph +61 (0)2 4272 4922 • Fax +61**  
**(0)2 4272 4677**

**Email [sales@australianlock.com.au](mailto:sales@australianlock.com.au)**  
**Web [www.australianlock.com.au](http://www.australianlock.com.au)**

### NEW ZEALAND

**PO Box 47169, Trentham, Upper Hutt,**  
**New Zealand**  
**Ph +64 272 875 625 • Fax +64 4970 2355**  
**Email [peterh@australianlock.co.nz](mailto:peterh@australianlock.co.nz)**  
**Web [www.australianlock.co.nz](http://www.australianlock.co.nz)**



Quality  
ISO 9001

Brochure 50 Rev.7





Whilst the Australian Lock Company Pty Ltd has taken every effort to ensure that the information in this catalogue is accurate at the time of publication, we recommend that you consult your Sales Representative to ascertain information in specific products and specifications prior to placing your order. Please note that we reserve the right to make changes without notice. The Australian Lock Company Pty Ltd will not be liable for any damage or loss arising from any errors or omissions in the information contained in this catalogue or arising from the use of the information contained herein.

**Australian Lock Company Pty Limited**

ABN 17 002 420 840

**AUSTRALIA**

17 Doyle Avenue, Unanderra NSW 2526 Australia  
PO Box 479 Unanderra NSW 2526 Australia  
Ph +61 (0)2 4272 4922 • Fax +61 (0)2 4272 4677  
Email [sales@australianlock.com.au](mailto:sales@australianlock.com.au)  
Web [www.australianlock.com.au](http://www.australianlock.com.au)

**NEW ZEALAND**

PO Box 47169, Trentham, Upper Hutt, New Zealand  
Ph +64 272 875 625 • Fax +64 4970 2355  
Email [peterh@australianlock.co.nz](mailto:peterh@australianlock.co.nz)  
Web [www.australianlock.co.nz](http://www.australianlock.co.nz)



Brochure 50 Rev.6